

# VILLAGE AT ONTARIO CENTER

SWC OF FOURTH STREET & MILLIKEN AVENUE, ONTARIO, CA



## PROJECT FEATURES

- +109,000 +/- sf Power Center anchored by Kohl's
- +Directly across from Ontario Mills at the Junction of the San Bernardino (I-10) & Devore (I-15) Freeways
- +Regional location
- +Almost 5 million people within a 30 mile radius

## DEMOGRAPHICS

Radius	1-Miles	2-Miles	3-Miles
Estimated Population	3,681	13,310	58,500
Estimated Avg. HH Income	\$83,195	\$88,117	\$86,815

## TRAFFIC COUNT

Milliken Ave.	36,366 cars/day
Concours St.	11,151 cars/day

Source: Inrix

**LEWIS RETAIL CENTERS**  
Lic. 1252241  
T. 909-946-7518  
[retailinfo@lewismc.com](mailto:retailinfo@lewismc.com)

**LEWIS**  
**RETAIL CENTERS**

Offered by Lewis Management Corp., a licensed real estate broker, DRE License 01994759. This information has been obtained from sources believed reliable. We have not verified it and make no guarantee, warranty or representation about it. Any projections, opinions, assumptions or estimates used are for example only and do not represent the current or future performance of the property. You and your property advisors should conduct a careful, independent investigation of the property to determine to your satisfaction the suitability of the property for your needs.



# VILLAGE AT ONTARIO CENTER

SWC OF FOURTH STREET & MILLIKEN AVENUE, ONTARIO, CA



**LEWIS**  
RETAIL CENTERS

# VILLAGE AT ONTARIO CENTER

SWC OF FOURTH STREET & MILLIKEN AVENUE, ONTARIO, CA

## TENANT

## SQFT

- 1 Take Ur Seat
- 2 Venice Nails
- 3 Miss U Day Spa
- 4 Dr. Su Pediatric Dentist
- 5 Sunrise Optometry

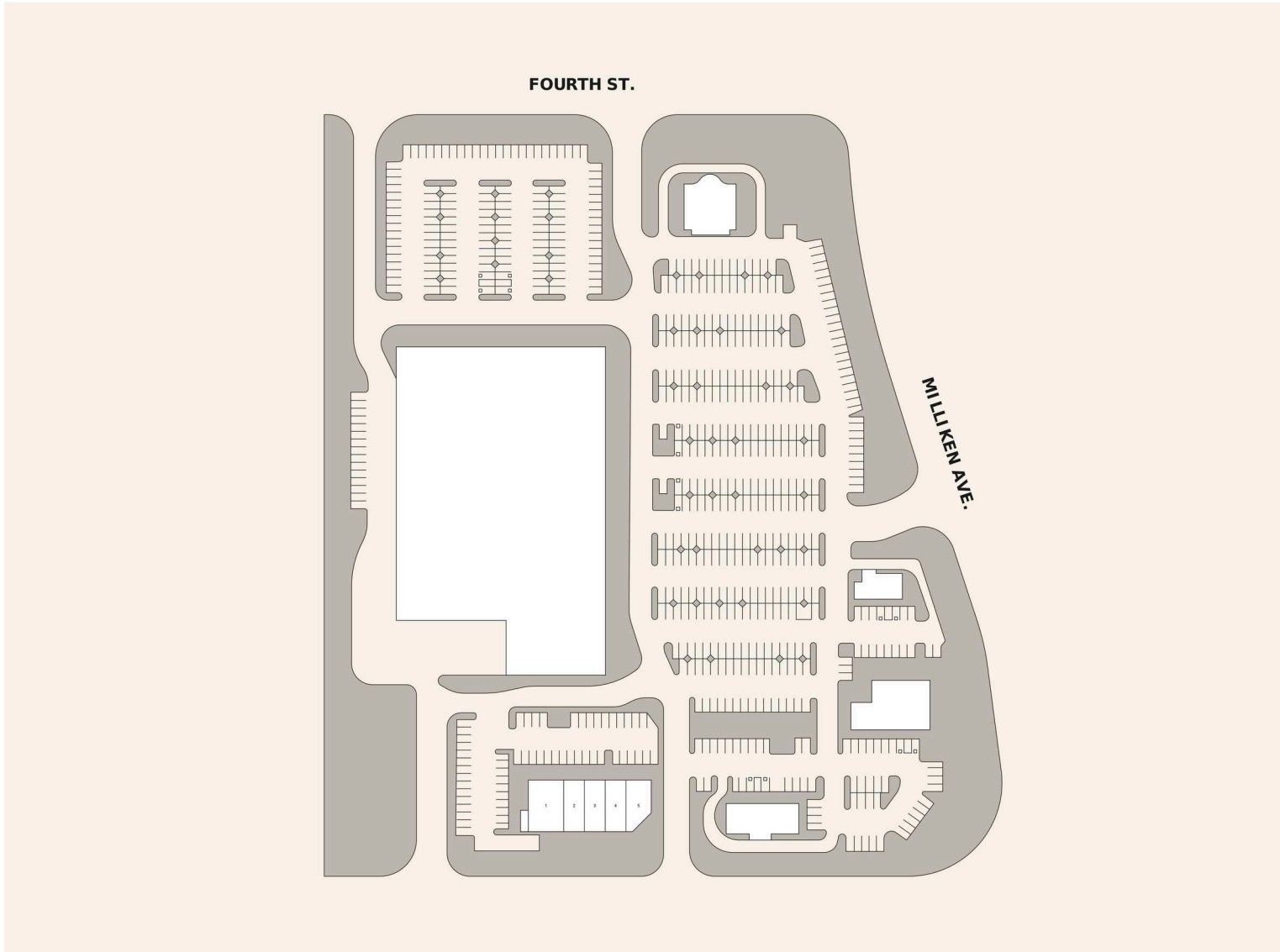

## LEWIS RETAIL CENTERS

Lic. 1252241

T. 909-946-7518

[retailinfo@lewismc.com](mailto:retailinfo@lewismc.com)

Offered by Lewis Management Corp., a licensed real estate broker, DRE License 01994759. This information has been obtained from sources believed reliable. We have not verified it and make no guarantee, warranty or representation about it. Any projections, opinions, assumptions or estimates used are for example only and do not represent the current or future performance of the property. You and your property advisors should conduct a careful, independent investigation of the property to determine to your satisfaction the suitability of the property for your needs.

**LEWIS**  
RETAIL CENTERS



# Summary Profile

2010-2020 Census, 2022 Estimates with 2027 Projections  
 Calculated using Weighted Block Centroid from Block Groups

Lat/Lon: 34.0749/-117.5595

<b>4275 Conours St</b>	<b>1 mi</b>	<b>2 mi</b>	<b>3 mi</b>
<b>Ontario, CA 91764</b>	<b>radius</b>	<b>radius</b>	<b>radius</b>
<b>Population</b>			
2022 Estimated Population	3,681	13,310	58,500
2027 Projected Population	3,674	13,268	61,695
2020 Census Population	3,682	13,304	56,296
2010 Census Population	4,044	12,196	48,539
Projected Annual Growth 2022 to 2027	-	-	1.1%
Historical Annual Growth 2010 to 2022	-0.7%	0.8%	1.7%
2022 Median Age	29.8	30.3	32.0
<b>Households</b>			
2022 Estimated Households	1,911	4,827	20,414
2027 Projected Households	1,962	4,949	22,032
2020 Census Households	1,913	4,806	19,933
2010 Census Households	1,778	4,059	16,590
Projected Annual Growth 2022 to 2027	0.5%	0.5%	1.6%
Historical Annual Growth 2010 to 2022	0.6%	1.6%	1.9%
<b>Race and Ethnicity</b>			
2022 Estimated White	33.1%	24.5%	31.1%
2022 Estimated Black or African American	22.2%	35.0%	18.8%
2022 Estimated Asian or Pacific Islander	13.0%	12.0%	14.0%
2022 Estimated American Indian or Native Alaskan	0.7%	1.0%	1.3%
2022 Estimated Other Races	30.9%	27.5%	34.8%
2022 Estimated Hispanic	38.7%	35.8%	44.4%
<b>Income</b>			
2022 Estimated Average Household Income	\$83,195	\$88,117	\$86,815
2022 Estimated Median Household Income	\$79,587	\$74,660	\$80,616
2022 Estimated Per Capita Income	\$43,200	\$35,079	\$31,015
<b>Education (Age 25+)</b>			
2022 Estimated Elementary (Grade Level 0 to 8)	2.1%	4.1%	5.1%
2022 Estimated Some High School (Grade Level 9 to 11)	1.7%	10.2%	7.0%
2022 Estimated High School Graduate	18.4%	18.4%	18.0%
2022 Estimated Some College	31.7%	28.6%	25.9%
2022 Estimated Associates Degree Only	13.1%	10.8%	10.8%
2022 Estimated Bachelors Degree Only	22.2%	19.6%	21.3%
2022 Estimated Graduate Degree	10.7%	8.2%	12.0%
<b>Business</b>			
2022 Estimated Total Businesses	1,382	4,778	7,937
2022 Estimated Total Employees	18,943	62,837	101,838
2022 Estimated Employee Population per Business	13.7	13.2	12.8
2022 Estimated Residential Population per Business	2.7	2.8	7.4